

INSTRUCTION MANUAL

Voltage probe 30~475MHz

01-00061B

NOISE LABORATORY CO., LTD

Edition 1.00

AEY00102-00E-0

Contents

1. IMPORTANT SAFETY PRECAUTIONS	1
2. INTRODUCTION	1
3. BASIC SAFETY PRECAUTIONS	2
4. PRODUCT COMPONENTS	3
5. SPECIFICATIONS	3
6. HOW TO USE	5
7. WARRANTY	6
8. MAINTENANCE	6
9. NOISE Laboratory Support Network	6
10. Application Form for Instruction Manual	7

NOTICE

- The contents of this instruction manual (the “Manual”) are subject to change without prior notice.
- No part of the Manual may be reproduced or distributed, in any form or by any means, without the authorization of Noise Laboratory Co., Ltd. (the “Company”).
- The contents of the Manual have been thoroughly examined. However, if you find any problems, misprints, or missing information, please feel free to contact our sales agent who you purchased our product from.
- The Company assumes no responsibility for any loss or damage resulting from improper usage, failure to follow the Manual, or any repair or modifications of this product undertaken by a third party other than the Company or the agent authorized by the Company.
- The Company assumes no responsibility for any loss or damage resulting from remodeling or conversion solely undertaken by the user.
- Please note that the Company cannot be held responsible for any consequences arising from the use of this product.

1. IMPORTANT SAFETY PRECAUTIONS

Important points for the safe use of this unit are provided below. Be sure to carefully read this information before use.

- Do not use this unit in areas where open flames are prohibited or areas having an explosive atmosphere. Electrical discharges can occur during use, which can cause these atmospheres to ignite.
- Do not allow people with pacemakers or other electronic medical devices to operate this unit and to enter the testing area while this unit is operating.
- The section "Basic Safety Precautions" contains important safety recommendations, and so be sure to read the section carefully before making the testing environment settings, connections, and starting testing.

2. INTRODUCTION

Thank you very much for your purchase of 01-00061B Voltage probe.

- This operation manual describes the function, operation and safety precautions of 01-00061B.
- Thoroughly read this operation manual before use and keep it as a ready reference.

3. BASIC SAFETY PRECAUTIONS

1. Safety Warning Signs and Their Meanings



Indicates **Warning**.

Failure to follow this safety information can lead to a **potentially hazardous situation** resulting in **death** or **serious injury**.



Indicates **Caution**.

Failure to follow this safety information can lead to a **potentially hazardous situation** resulting in a **minor injury** or **moderate damage**.

2. Basic Safety Precautions



1. Do not use this unit in areas where open flames are prohibited or areas having an explosive atmosphere. Electrical discharges can occur during use, which can cause these atmospheres to ignite. (Precaution regarding personal safety and environment)
2. Do not allow people with pacemakers or other electronic medical devices to operate this unit and to enter the testing area while this unit is operating. Failure to observe this can result in malfunctions in the electronic medical device and endanger personal safety. (Precaution regarding personal safety and operation)
3. Noise Laboratory and our affiliated dealers are not liable for any injuries or equipment damage due to improper operation of this unit or for any resulting incidental damages. (Precaution regarding personal safety, operation, environment, and connection)
4. When operating this unit, do not leave the equipment unmonitored. Before leaving this unit, be sure to turn off test equipment power and terminate testing. If you fail to observe this, you could endanger people in the surrounding area and testing equipment. (Precaution regarding personal safety, operation, and environment)



5. Do not use or store in environments with extremely hot or cold temperatures. If you cannot maintain a suitable operating environment (temperature: 15°C to 35°C, humidity: 25% to 75%), the unit can be damaged and result in impaired performance. (Precaution regarding environment)
6. In the event that condensation forms, be sure that the unit is fully dried before starting operation. Failure to observe this can damage the unit and result in impaired performance. (Precaution regarding environment)
7. Avoid using the unit in locations with high humidity or exposed to large amounts of dust. Failure to observe this can damage the unit and result in impaired performance. (Precaution regarding environment)
8. Do not wipe the unit with thinner, alcohol, or other solvents. If the unit is dirty, wipe with a cloth dipped in neutral detergent

after it is fully wrung out. Wiping with a solvent can damage the unit surface.

4. PRODUCT COMPONENTS

- Capacitor BOX 1 個

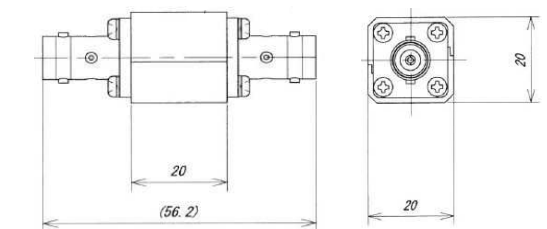

(Wiring diagram)

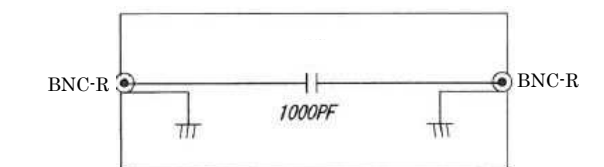

- Measurement clip 1

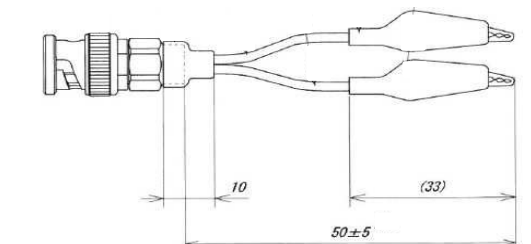

(Wiring diagram)

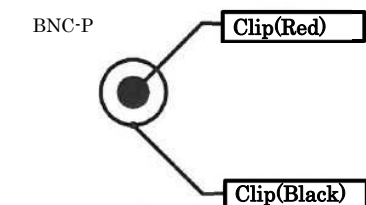

- Coaxial cable 1

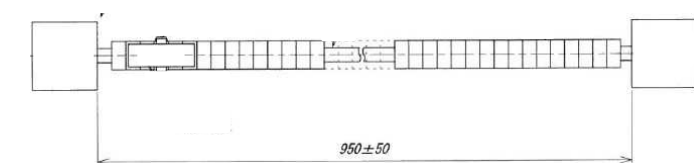

(Wiring diagram)



- Instruction manual 1

5. SPECIFICATIONS

Item	Spec./Performance
Frequency range	30MHz~475MHz
Transmission loss※	30MHz~240MHz ≤2dB 240MHz~475MHz ≤4dB
Length	950mm±50mm(Coaxial cable)
	50mm±5mm(Measurement clip)
Maximum Voltage	50V _{dc}
Operating temperature range	15~35°C
Operating humidity range	25~75% (no condensation)

※When the measurement clip opening angle is 0 degrees.

6. HOW TO USE

Connect the measurement clip and coaxial cable to the capacitor box.

7. WARRANTY

Services

The following terms are applicable to the services provided by the Company to maintain and repair the Unit.

1.Scope

The Unit and accessories and options provided by the Company are covered under this section.

2.Technical Service Fee

Any repairs provided by the Company during the warranty period will be free of charge in accordance with the Limited Warranty. After expiration of the warranty period, actual cost for the repair will be charged to the user.

3.Ownership of Defective Parts

All the defective parts replaced during the warranty period become the property of the Company. For paid repairs, they also become the property of the Company unless otherwise directed by the user.

4.Maximum Compensation

In the event the user incurs damage due to malfunction of the Unit arising solely from the negligence and/or improper repair on the part of the Company, the Company will compensate for the damage. The maximum compensation amount shall be limited to the amount paid by the user at the time of purchase of the Unit. In no event, shall the company be liable or in any way responsible for incidental or consequential damages such as loss of profit or third party's claims to the user.

5.Wrong Parts, Missing Parts and Damage

The company shall not be liable for loss of profit, business interruption, other incidental damage, special loss, punitive damage or third party's claims to the user directly or indirectly arising from suspension of testing activities due to wrong parts, missing parts, or damage of the Unit.

6.Service Refusal

The company may not accept a repair order in the following cases:

- More than 5 years have passed since the product discontinued
- More than 8 years have passed after delivery
- Required component for servicing already discontinued and no alternative is available.
- Product changed, repaired or remodeled without obtaining a prior permission from the Company.
- Product severely damaged to the extent it has lost its original form

8. MAINTENACE

1. Maintenance on the user side is restricted to the outside cleaning and functional check of the Unit.
2. When cleaning the Unit, turn off the switch of the Unit and the connected equipment and disconnect the plug socket beforehand.
3. Avoid using chemicals for cleaning. Otherwise, the coating of the Unit may peel off or the sight glass may be broken.

9. Noise Laboratory Support Network

- If a symptom which seems a trouble is found, inform the model name and serial number of the product together with the symptom to Noise Laboratory or your nearest sales agent of Noise Laboratory.
- When the product is returned to Noise Laboratory, write the state of the trouble, contents of your request, model name and serial number in a repair order, and pack the product and repair order sheet in the former package of equivalent suitable for transit and send them back.

NOISE LABORATORY CO., LTD.
SALES DEPT.

TEL: +81-42-712-2051
FAX: +81-42-712-2050

E-mail: sales@noiseken.com
<http://www.noiseken.com>

----- Cutline -----

11. Application Form for Instruction Manual

We place an order for an instruction manual.

Model: 01-00061B
Serial No.: 

Applicant: _____
Company name: _____
Address: _____

Department: _____
Person in charge: _____
Tel No.: _____
Fax No. _____

Cut off this page "APPLICATION FORM FOR INSTRUCTION MANUAL" from this volume and keep it for future use with care.

When an INSTRUCTION MANUAL is required, fill in the above Application Form and mail or fax it to the following sales department of our company.

To: NOISE LABORATORY CO., LTD.
1-4-4 Chiyoda, Chuo-Ku, Sagamihara City,
Kanagawa Pref. 252-0237 Japan
Tel: +81-42-712-2051 Fax: +81-42-712-2050